

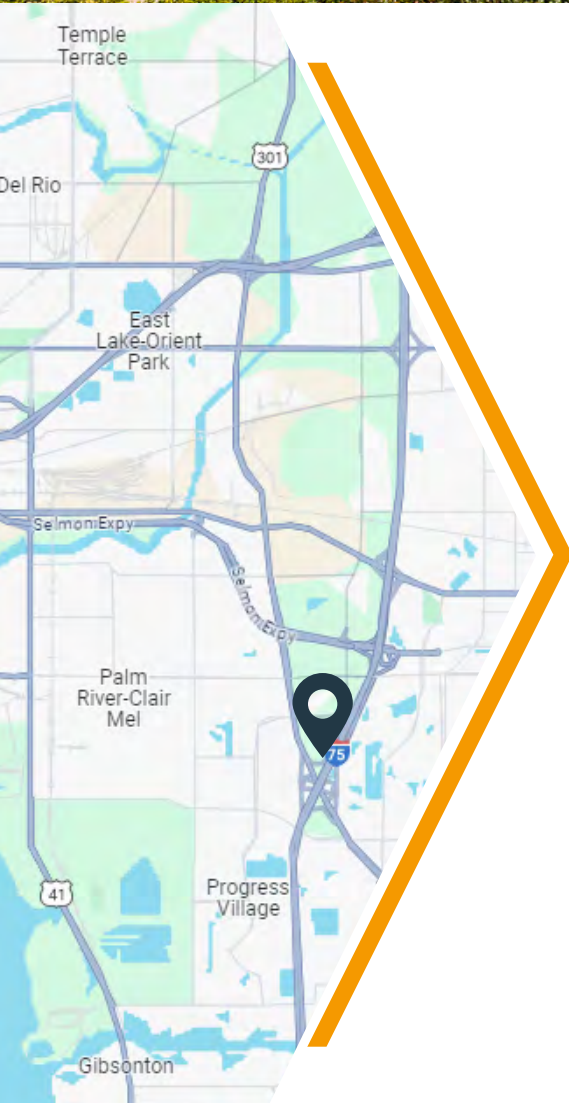

## Prime 9,144 SF Industrial Space Available

- » Warehouse + Office Mix including private offices, conference rooms, cube areas, and break room
- » 14' clear ceiling height allowing efficient racking and vertical storage
- » Large bay door for easy loading and unloading
- » Immediate access to I-75 and US-301 for strong regional connectivity and distribution routes
- » Ideal for logistics, light manufacturing, distribution, or service operations



Demographics	1-mile	3-miles	5-miles
2025 Population	14,364	103,662	197,780
Daytime Employment	2,905	35,511	87,840
Average HH Income	\$87,097	\$90,158	\$94,893
Median Age	35.2	36.6	37.9

**Leasing Contact:** Heather McMillin | Senior Vice President, Retail Leasing  
(Office) 813-533-0852 | [hmcmillin@rpm-realty.com](mailto:hmcmillin@rpm-realty.com)



# CRESCENT PARK

4035 Crescent Park Dr., Riverview, FL 33578



The information contained herein was obtained from sources believed reliable; however, RPM Realty Management, LLC makes no guarantees, warranties, or representations as to the completeness or accuracy thereof. The presentation of this property is submitted subject to errors, omissions, change of price or conditions prior to sale or lease, or withdrawal without notice.



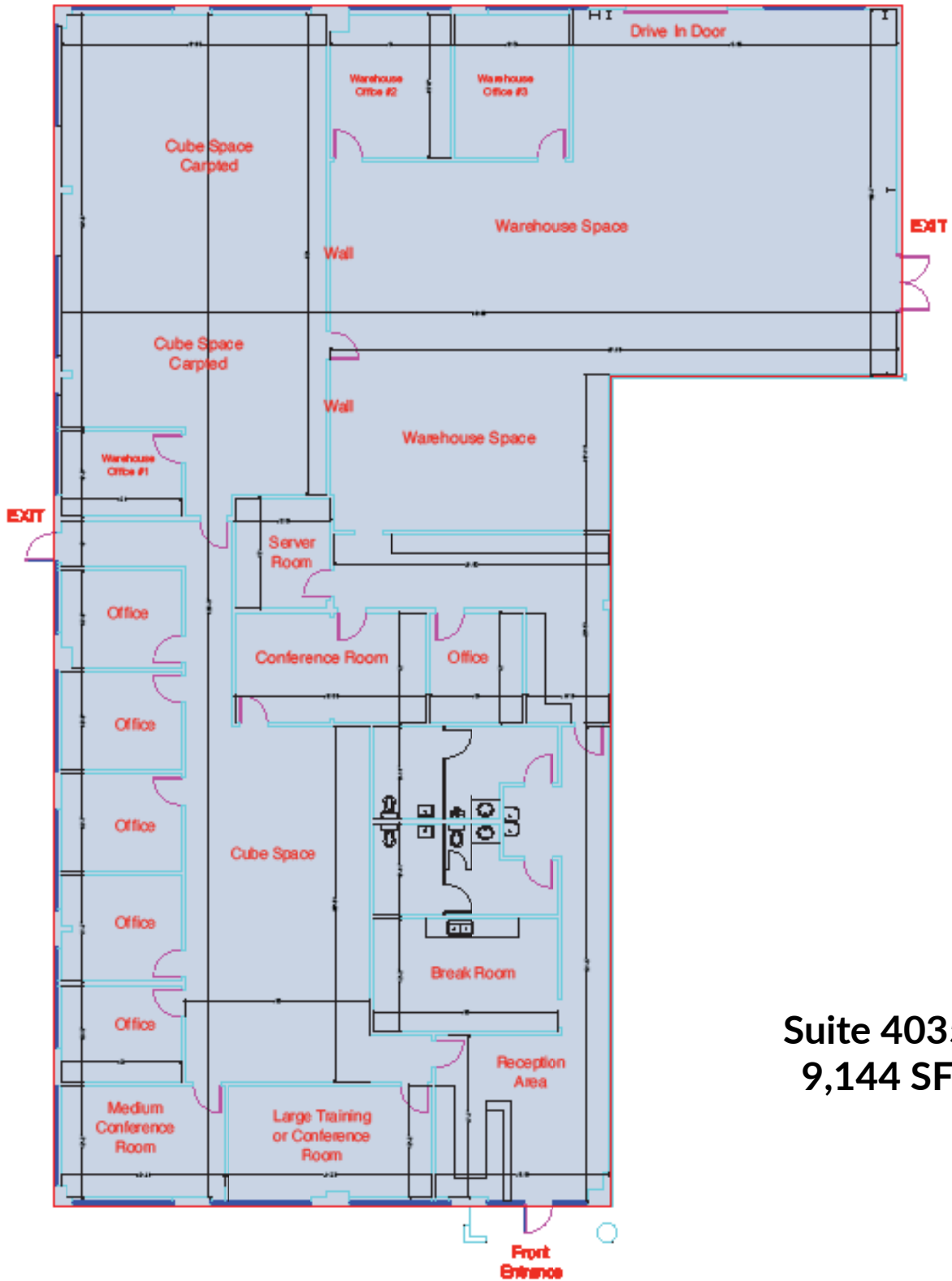

**Suite 4035**  
**9,144 SF**

The information contained herein was obtained from sources believed reliable; however, RPM Realty Management, LLC makes no guarantees, warranties, or representations as to the completeness or accuracy thereof. The presentation of this property is submitted subject to errors, omissions, change of price or conditions prior to sale or lease, or withdrawal without notice.

