

JACKSON SPRINGS SQUARE

7345 Jackson Springs Rd, Tampa, FL 33634



REDEVELOPMENT/ LAST SPACE - 1,652 SF AVAILABLE

- » 12,073 SF mixed-use, retail/office development
- » Situated in the heart of the Town 'N' Country submarket, directly off Hanley Road near Tampa International Airport
- » Minutes from Tampa Community Hospital
- » Town 'N' Country has a high population density of 215,140 people within 5 miles
- » 2022 Hanley Rd Traffic Counts: 22,181 AADT

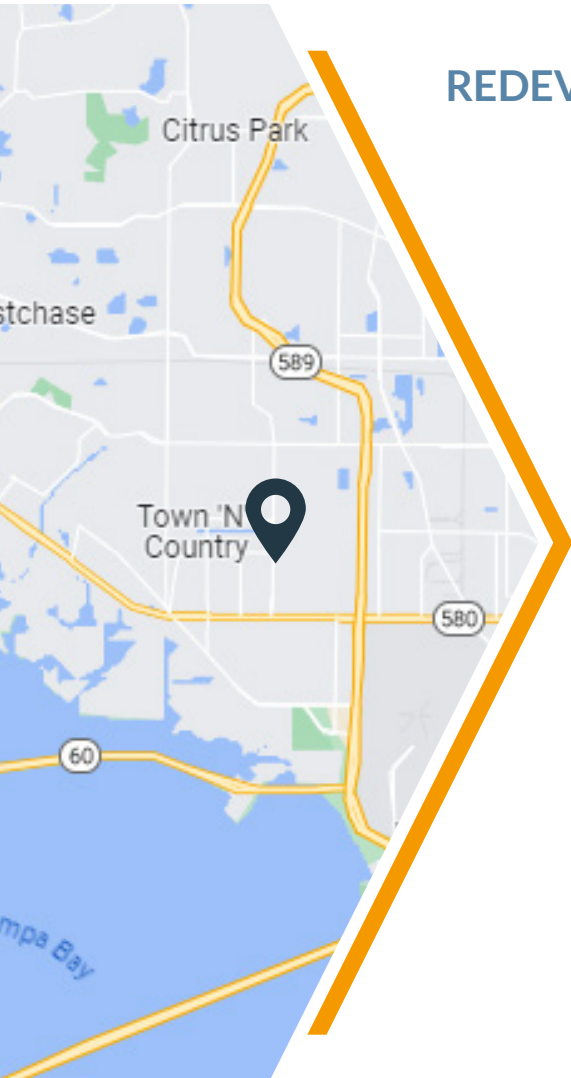

Demographics	1-mile	3-mile	5-mile
2023 Population	16,684	91,894	215,140
Average HH Income	\$73,609	\$77,351	\$80,741
Median Age	39.7	39.7	39.4
Daytime Employment	4,368	50,711	145,886

Leasing Contact: Wanda De Boer | Managing Director - Retail Services
(Cell) 813-690-3020 | (Office) 813-269-0702 | wdeboer@rpm-realty.com



JACKSON SPRINGS SQUARE

7345 Jackson Springs Rd, Tampa, FL 33634

Suite	Tenant	SF
A	JSV Clinical Research	1,099
B	World of Learning	2,272
1	J & J Barber	797
2	Pet Parlor	1,501

C.1	Tairi Nieves Nail Spa	1,131
C.2	AVAILABLE	1,652
C.3	Medical Exams of Tampa	1,143
C.4	Daylin Fitness	1,143
D	Paradise Arenas Blancas	1,156

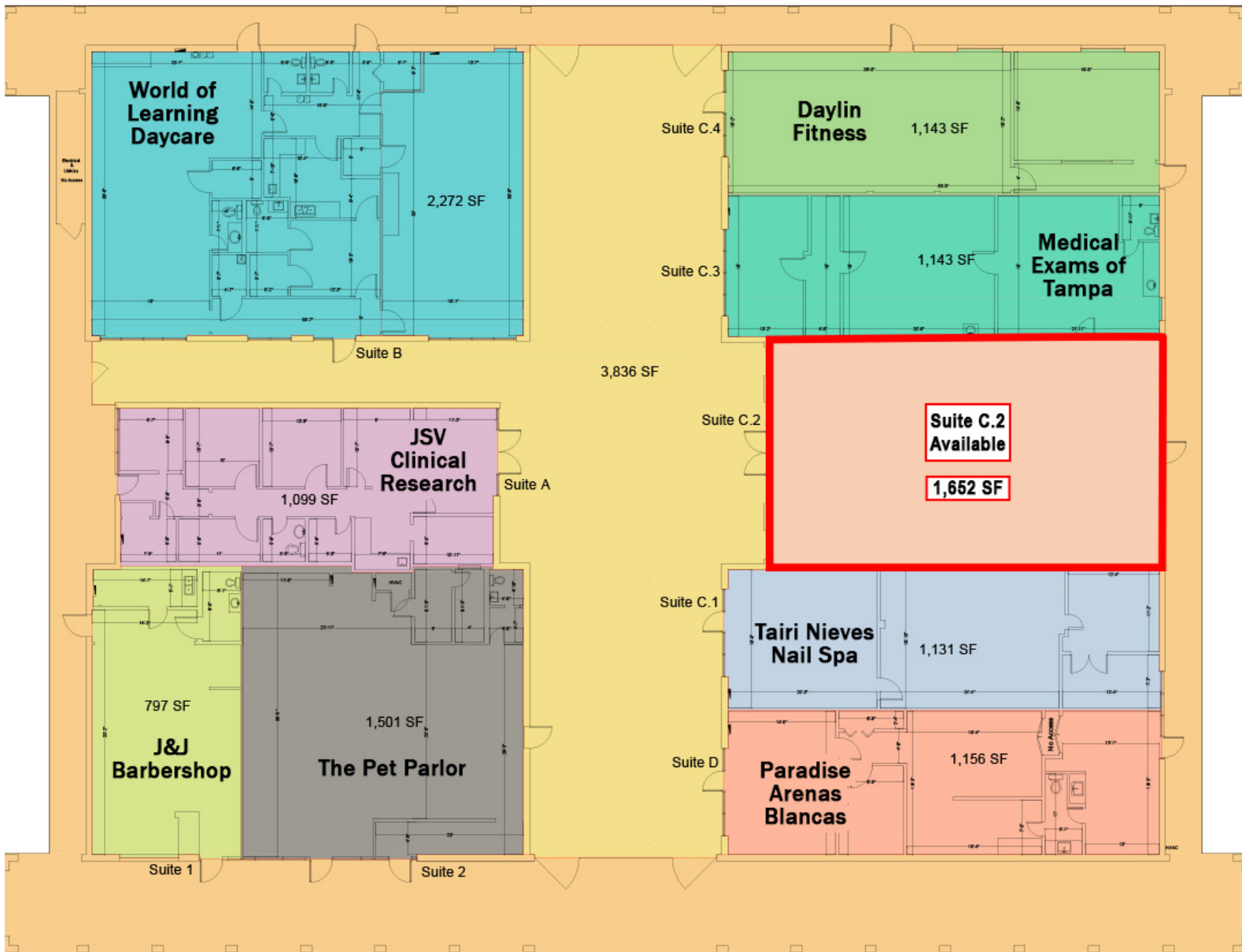

The information contained herein was obtained from sources believed reliable; however, RPM Realty Management, LLC makes no guarantees, warranties, or representations as to the completeness or accuracy thereof. The presentation of this property is submitted subject to errors, omissions, change of price or conditions prior to sale or lease, or withdrawal without notice.

