

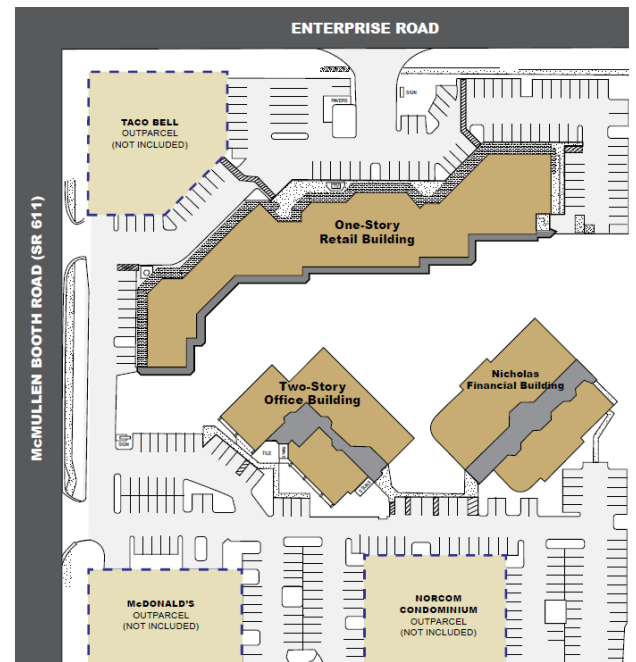

## LOCATED AT CLEARWATER'S MOST DESIRABLE INTERSECTION

### Property Information

- SEC McMullen Booth Road and Enterprise Road
- Strategically located between SR 60 and SR 580
- Offices from 1,095 SF to 1,140 SF
- Two-story office building with stunning, natural creek views
- Within close proximity to Bay Area airports
- Parking Ratio: 4.3/1,000 SF
- 24/7 access
- Located in Countryside, near retail shops, restaurants and services
- Convenient lunch break and "after hours" accessibility



### Leasing Contact:

Wanda De Boer | Managing Director - Retail Services

(Cell) 813-690-3020 | (Office) 813-269-0702 | [wdeboer@rpm-realty.com](mailto:wdeboer@rpm-realty.com)



# Northwood Commons Professional Offices

2454 N McMullen Booth Rd., Clearwater, FL 33759

1st Floor



SUITE	TENANT
401	Mary Ellen Borja, PA Marital & Family Law
402	UAW FCA Ford GM Legal Services
403	R-Salon
404	Roth Brothers
409	NES Water Metering
410	AVAILABLE - 1,095 SF
411	AVAILABLE - 1,140 SF

SUITE	TENANT
421/423	Craig Duncan/State Farm
424	Clear Skin Dermatology
426	Lease Pending
427	SMC
428	SMC
429	Light Tree, LLC
430	Lease Pending
431	Benevity

2nd Floor

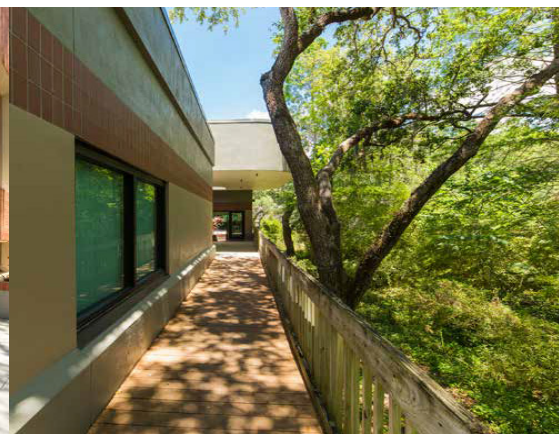
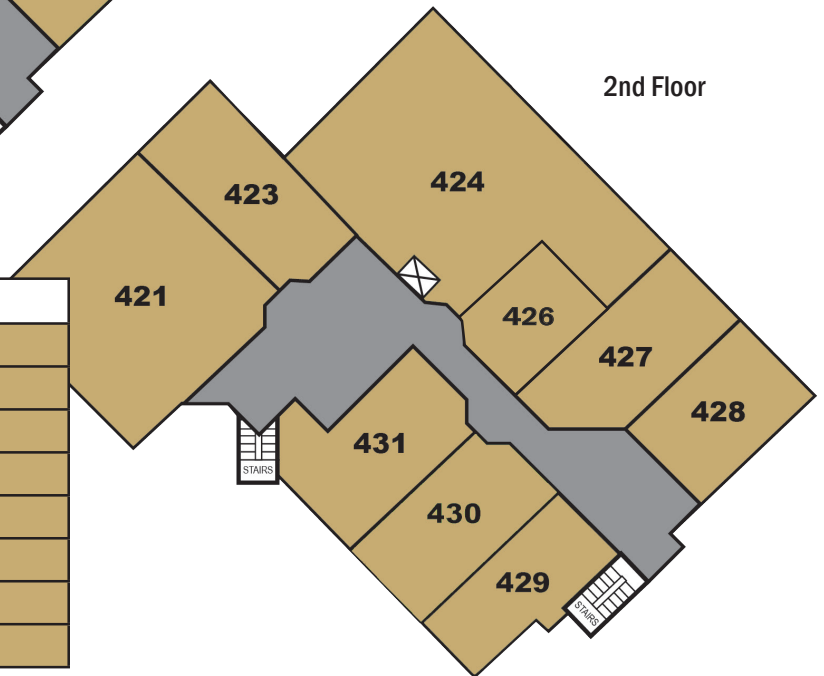

The information contained herein was obtained from sources believed reliable; however, RPM Realty Management, LLC makes no guarantees, warranties, or representations as to the completeness or accuracy thereof. The presentation of this property is submitted subject to errors, omissions, change of price or conditions prior to sale or lease, or withdrawal without notice.



# Northwood Commons Professional Offices

2454 N McMullen Booth Rd., Clearwater, FL 33759



The information contained herein was obtained from sources believed reliable; however, RPM Realty Management, LLC makes no guarantees, warranties, or representations as to the completeness or accuracy thereof. The presentation of this property is submitted subject to errors, omissions, change of price or conditions prior to sale or lease, or withdrawal without notice.

